

## PRINCIPAL'S MESSAGE

When you walk into the front entry of North Point Elementary you will see 14 stars displayed on the upper wall that form the constellations of the Big and Little Dipper. The largest star on the wall is Polaris, or the North Star.



Ancient Mariners used the North Star to Navigate by. They knew that this star was constant. It never moved and stayed in the same spot in the northern sky. This star helped them know where they were and helped them point the way to where they were going.

The motto of North Point Elementary is **“Pointing the Way to the Future.”** We use the North Star as a symbol of that motto. Our responsibility at North Point Elementary is to help safely navigate our students along their educational journey. As their navigators we must know what their destinations are, then plan and prepare for their journey. We must constantly measure to know where they are to make sure they are on course. We must make course corrections if necessary. We must look to those steady and true principles and values as we **“Point the way to the Future”** for our students.

Sincerely,  
Mr. Kim Roper - Principal

## North Point's Extended Day Model

North Point's Extended Day Model focuses on a philosophy of teaming. Each teacher's class is divided into two tracks. The early track attends school from 8:00 until 2:15 and the later track attends from 9:15 until 3:30. The greatest advantage our model offers is a block of time every day from 8:00 until 9:15 and again from 2:15 until 3:30, when teachers have very small classes. We are very protective of this “Small Group Instruction Time” and consider it the most important time of the day.

During this period there are no interruptions to instruction: no recess, no announcements, no assemblies, or gym. NO Interruptions! Please help us protect this valuable instructional time by not calling to speak with teachers or students during this time. With this uninterrupted time and small class sizes, teachers are able to focus on improving student skills in math, reading and writing.

## ABOUT OUR SCHOOL

North Point Elementary opened its door for the first time to students in 2009. Our school is now in its 6<sup>th</sup> year of operation. North Point has 34 regular education and 6 special use classrooms. We have 13 additional portable classrooms. We have a campus of 13 acres.

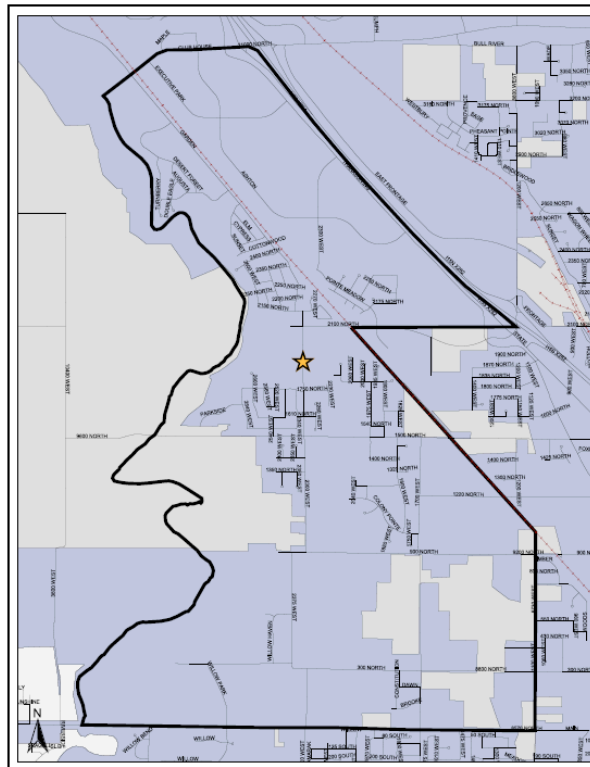
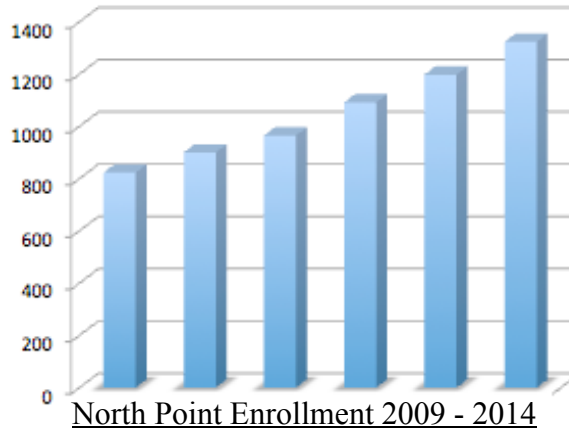

**North Point Elementary Boundary Map**

# North Point Elementary

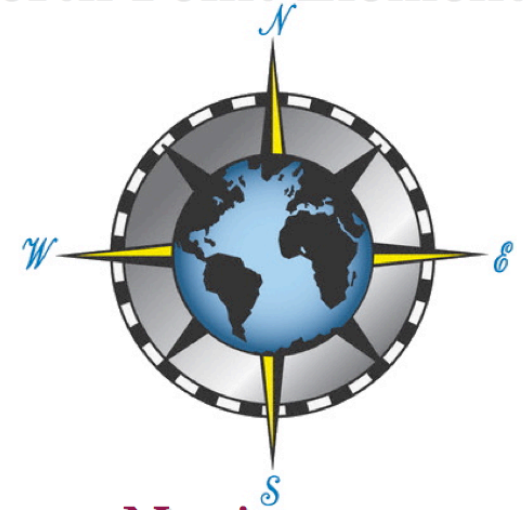

**Navigators**

*Pointing the way to the Future!*

**SCHOOL**  
report  
card

**2014-2015**

# 2014-15 Trustlands Plan

## Goal #1 (K-2 Reading)

*Our goal is to have 90% of K-2 students reaching 2015 Winter DRA benchmark.*

We will spend the following Trustlands Expenditures to achieve our goal.

- ⇒ We will pay our 1<sup>st</sup> and 2<sup>nd</sup> grade teachers 10 hours each to give the DRA to their students before school starts in August. (August 11-13, 2014) **\$2,625.00**
- ⇒ We will hire an aide to run and maintain our Home Reading Library. **\$2,000.00.**
- ⇒ We will hire DOUBLE DOSE aides to work 5 hours per day to help our DOUBLE DOSE TEACHERS provide Tier II reading interventions for K-2 students. **\$4,500.00 + \$3,600.00 matching District Funds.**
- ⇒ We will place three Kindergarten teachers on the Modified Extended Day Model to allow for small group instruction time for our Kindergarten students from 8:00 until 9:15 and from 10:45 until 12:00. **\$22,111.00**
- ⇒ We will hire 3 teachers to plan, recruit, and instruct a Summer Jump Start Program for students about to enter 1<sup>st</sup>, 2<sup>nd</sup> & 3<sup>rd</sup> grades. This 10 day program will have 15 students per class and will take place from July 28<sup>th</sup> through August 8<sup>th</sup>. **\$3,000.00**
- ⇒ We will purchase additional Guided Reading Books (Levels J-L) for our 1<sup>st</sup> grade teachers to supplement their classroom libraries that are lacking books for the new higher reading benchmarks. **\$2,600.00**
- ⇒ We will purchase additional books for our Home Reading Library. **\$1,500.00.**

## Goal #2 (3-6 Literacy)

*Our goal is to have 80% of our students reach proficiency level in Language Art/Writing as measured by the new State SAGE Assessments.*

We will spend the following Trustlands Expenditures to achieve our goal.

- ⇒ We will pay for teachers to attend Literacy Conferences and Conventions during the 2014-2015 school year. **\$1,000.00.**
- ⇒ We will pay for substitute teachers that will allow teachers to attend professional development conferences and conventions. **\$300.00**
- ⇒ We will purchase Chrome Books for our 4<sup>th</sup> grade students to use to improve keyboarding and writing skills. **\$15,668.00.**
- ⇒ We will purchase Close Reading Books for our 6<sup>th</sup> grade teachers to use during Small Group Literacy Instruction Time. **\$1,575.00**
- ⇒ We will hire DOUBLE DOSE aides to work 5 hours per day to help our DOUBLE DOSE TEACHERS provide Tier II reading and math interventions for 3-6<sup>th</sup> grade students. **\$4,500.00 + \$3,600.00 matching District Funds.**
- ⇒ We will provide Summer Collaboration Grants for teacher to have additional training and DRA assessment standards. **\$4,000.00**
- ⇒ We will purchase additional books for our Guided Reading Library (Levels M-P). **\$3,000.00.**

# Average Class Sizes

Enrollment October 1, 2014 – (1320 students)

Grade	Enrollment	Average	Average* Student/Teacher/Hour
Pre-Sch.	34		
Kinder	207	25.8	22.5
1 <sup>st</sup>	211	26.4	21.6
2 <sup>nd</sup>	174	24.9	20.4
3 <sup>rd</sup>	186	26.6	21.8
4 <sup>th</sup>	188	31.3	25.6
5 <sup>th</sup>	156	28.4	23.3
6 <sup>th</sup>	164	29.8	24.4

\*Average Student/Teacher/Hour ratio with our Extended Day split Literacy Schedule.

# Student Demographics

Caucasian .....	90%
Race/Ethnic Minority .....	10%
Students with Disabilities .....	12%
Chronic Absenteeism .....	25%
Low Socio-Economic .....	16%
Limited English Proficient.....	2%
Average Daily Attendance.....	96%
Mobility Rate .....	9%
Male 47.8%	Female 52.2%

# Teachers & Staff

Certified Teachers.....	55
Average Teaching Experience .....	8.32
Administration .....	2
Contracted Classified Staff.....	5
(Media, Custodian, Secretarial, Lunch Manager)	
Hourly Classified Staff .....	20
(Aides, Sweepers, Lunch Workers)	
Other Staff.....	5
(TSA, Nurse, Psychologist, Speech, Techs)	
Total .....	87

# Student Achievement

## 3rd Grade Reading Proficiency

